

Hydrogen Inhaler Pulmovolta® Highdrogen H2K

User Manual

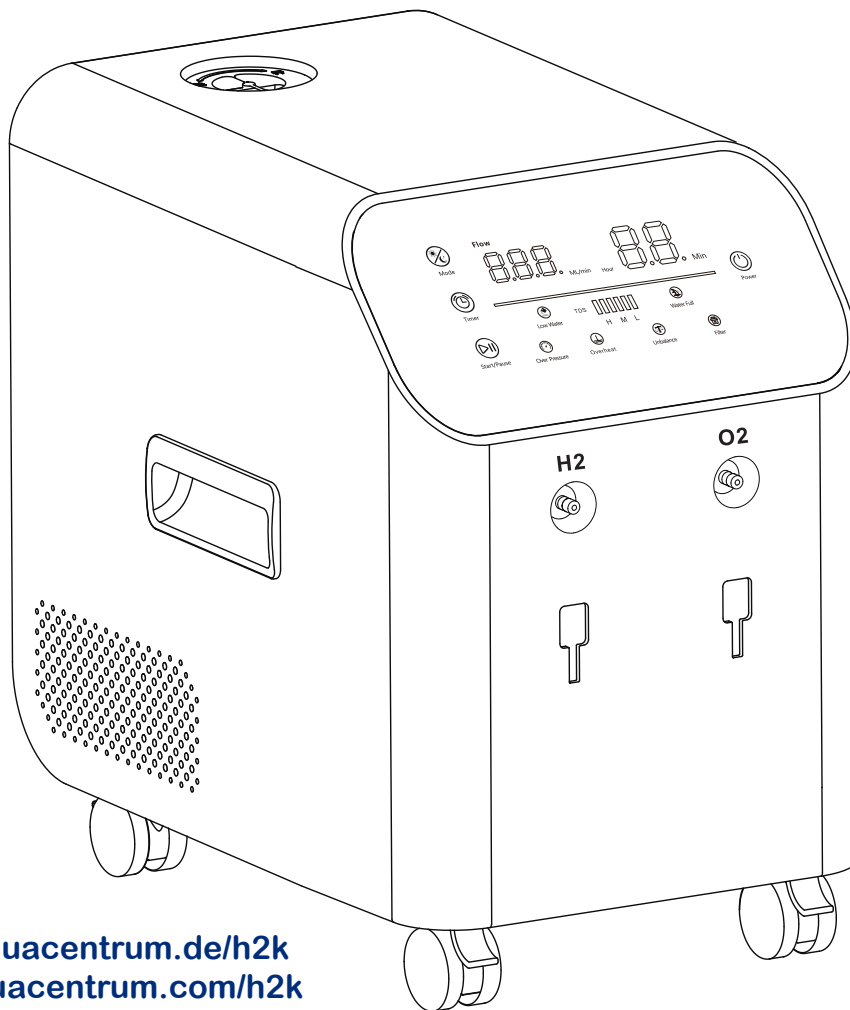

www.aquacentrum.de/h2k
www.aquacentrum.com/h2k
www.aquacentrum.es/h2k
www.aquacentrum.fr/h2k
www.aquacentrum.it/h2k
www.aquacentrum.com.tr/h2k

CONTENTS

1. Function & Feature	1
2 Product Introduction	1
3. Basic Setup	2
4. Operation	4
5. Smart Sensor	6
6. Changing water / Draining water	9
7.Connection Demonstration for Multi-Users	10
8 .Maintenance	11
9 .FAQ	11
10.Warning & Precautions	12
11. Warranty Policy	13

Note:

When the outdoor temperature is lower than 5°C, the equipment must be placed at room temperature for 24 hours before use!

1.FUNCTION & FEATURE



The default hydrogen outputs 2000ml/min, and the default oxygen outputs 1000ml/min, the total gas output is 3000ml/min.

TDS

TDS Water Quality Sensor is equipped to monitor the water quality in the water tank in real time.



Machine tilt alarm sensor. Built-in overheating, over-current multiple protection sensors. Super intelligent and safe to use.



Built-in Resin Filter to reduce water's impurity (TDS level), to make purer and safer Hydrogen.

2.PRODUCT INTRODUCTION

MAIN UNIT

- ① Function Display
- ② Operation Panel
- ③ Hydrogen Outlet (H₂)
- ④ Oxygen Outlet (O₂)
- ⑤ Humidifier Bottle Buckles

- ⑥ Distilled Water Inlet
- ⑦ Machine Handles
- ⑧ Water Level Indicator
- ⑨ Water Drain Hole
- ⑩ Power Cord inlet
- ⑪ Power Switch

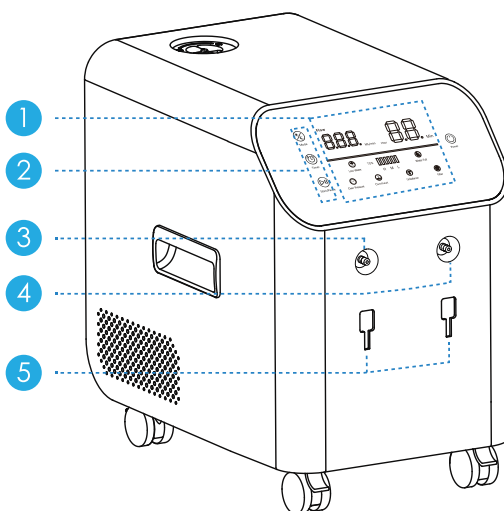

(FRONT)

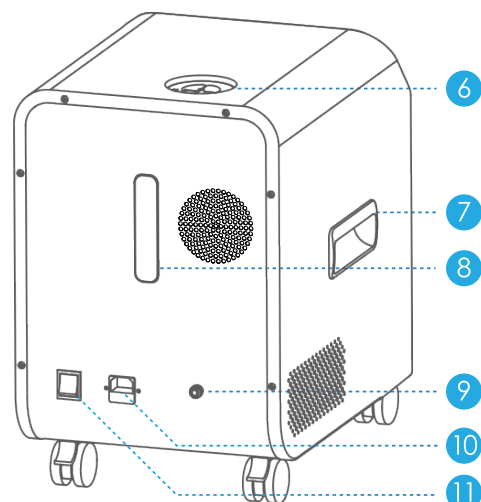

(BACK)

PACKING LIST

No.	Accessory	Quantity	Notes	Warranty Period
1	Main Unit	1 PC		1 Year
2	Nasal cannula	1 PC	Consumable (Replace every 1-2 months)	—
3	Humidifier bottle	2 PCS		—
4	Connecting tube (7 cm)	2 PCS		—
5	Resin Filter	2 PCS	1 pc installed in water tank 1 pc as spare part	Consumable (Replace every 6 months)
6	Gas connecting tube (55 cm)	2 PCS	Consumable	—
7	Y shape connector	1 PC	Consumable	—
8	Nasal Cannula & water collector (green)	1 PC		—
9	Drain tube	1 PC		—
10	User manual	1 PC		—
11	Fuse	2 PCS	1 pc installed in the Power Switch 1 pc as spare part	—
12	Power Cable	1 PC		—

3. BASIC SETUP

Fill the humidifier bottles with an appropriate amount of Distilled water (between the Min & Max level).

1

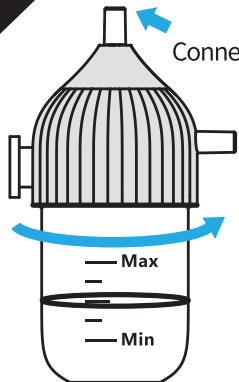

Connect connecting tubes (7cm) to the outlets on the machine

A. Turn counter clockwise to open the cap.
B. Fill the bottle with distilled water in between the Min & Max water indicator line.

⚠ When water reaches the Max line, open the bottle and remove to the middle line where gas tube can still go through the water.

Humidifier Bottle

Connect one end of the connecting tube (7cm) to the outlet on the machine, and the other end to the top inlet of the humidified bottle.

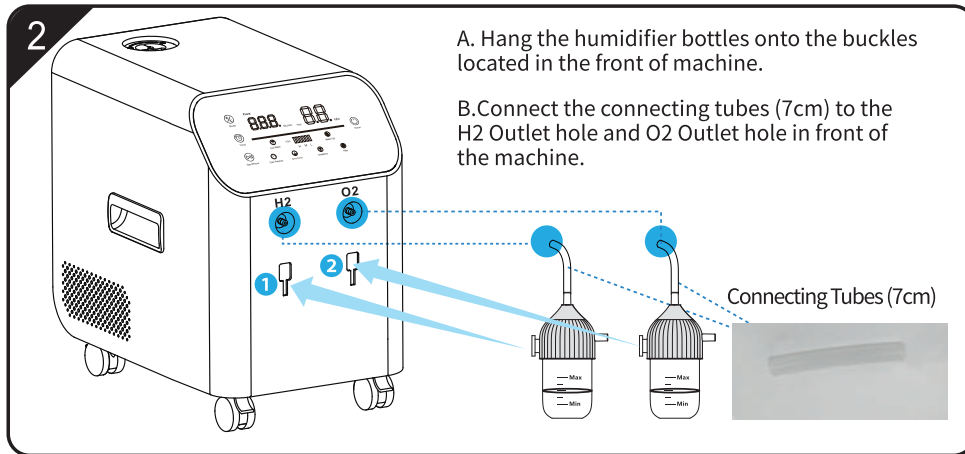

Connect the nasal cannula tube to the output of the humidifier bottles.

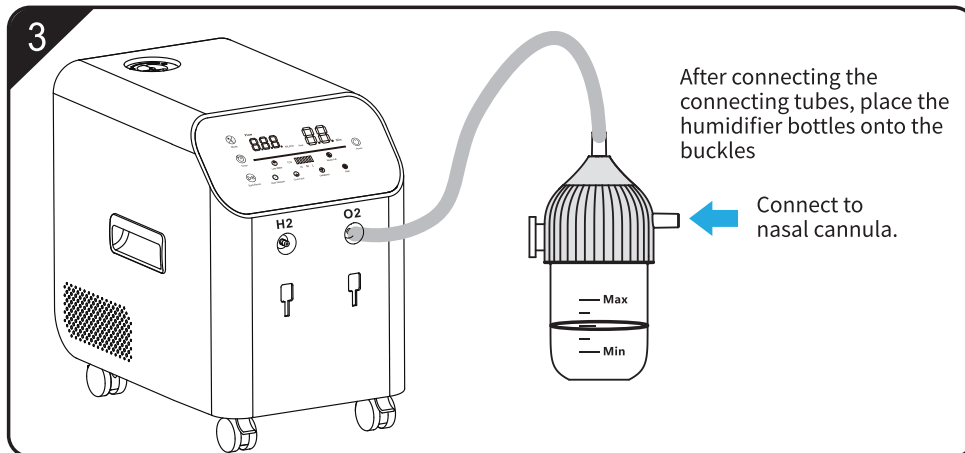

Connect the power cable to the device & then plug it into the wall.
Then turn on the Power Switch on the back of the machine.

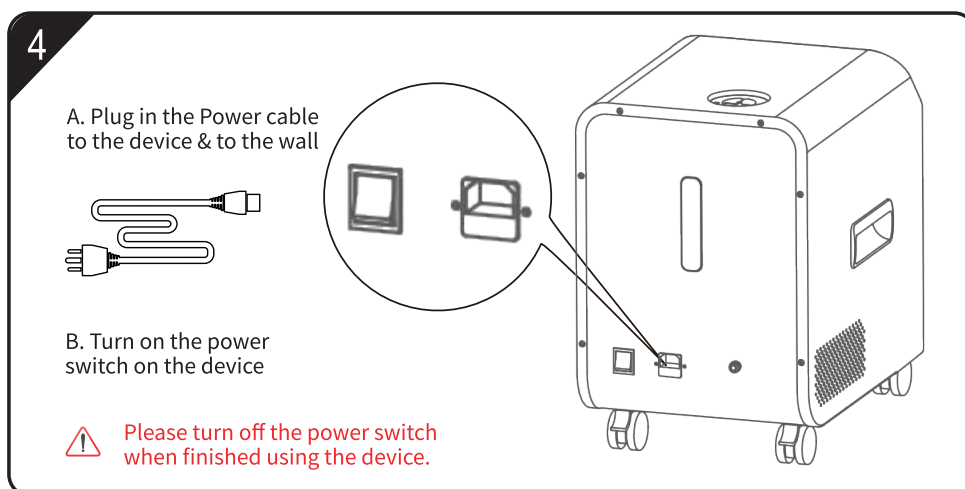

Fill 2L-2.6L of distilled water (TDS=0) into the tank (Note: 2.6L is the maximum water level, 1L is minimum water level) , and tighten the tank cover.

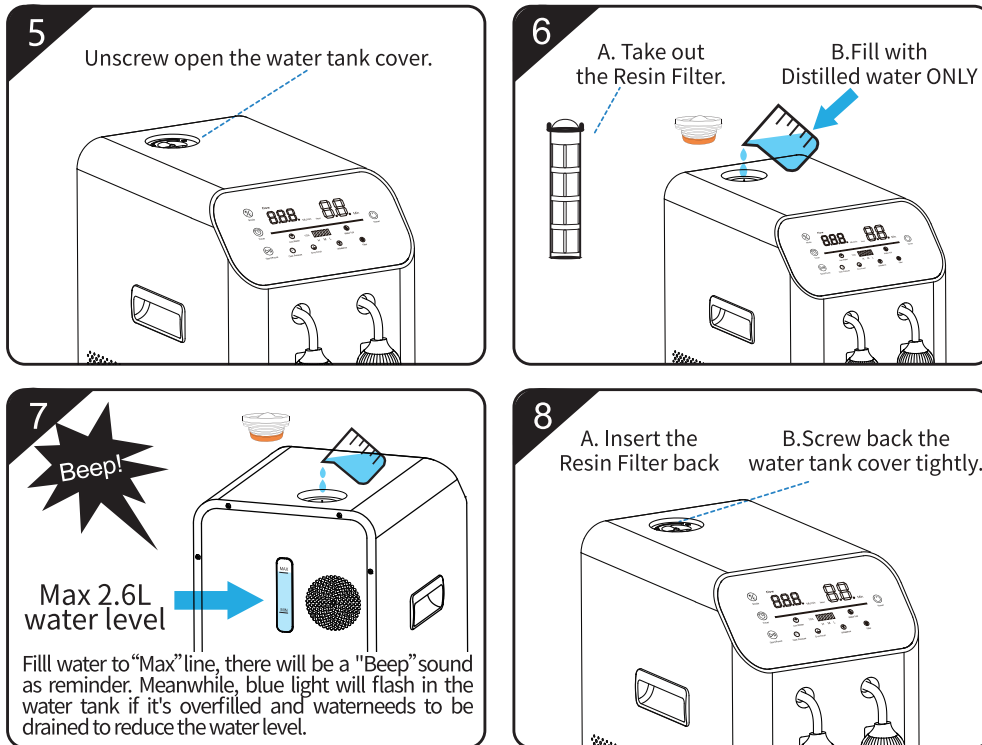

4. OPERATION

① Connect nasal cannula.

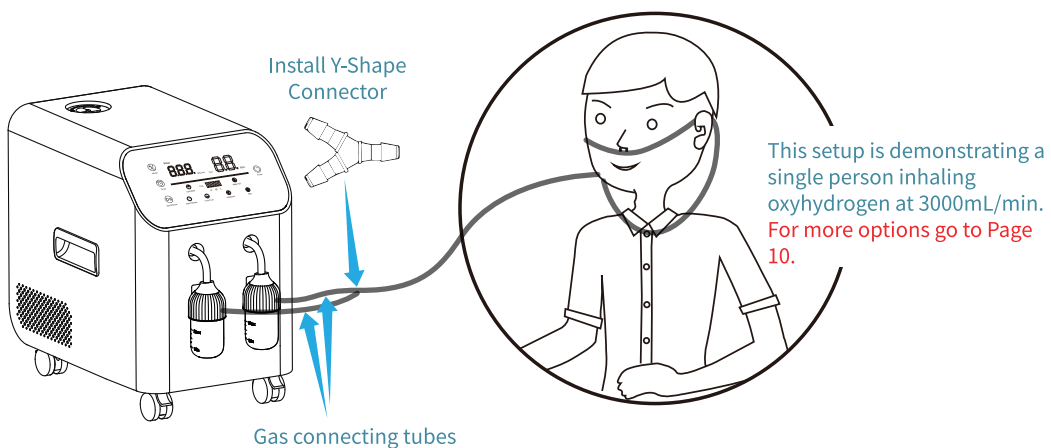

Go to Page 10 to see Oxyhydrogen & Multiuser setups.

- ② The Display Panel will light up when Power Switch is turned on, long press “Power” to light up whole panel.

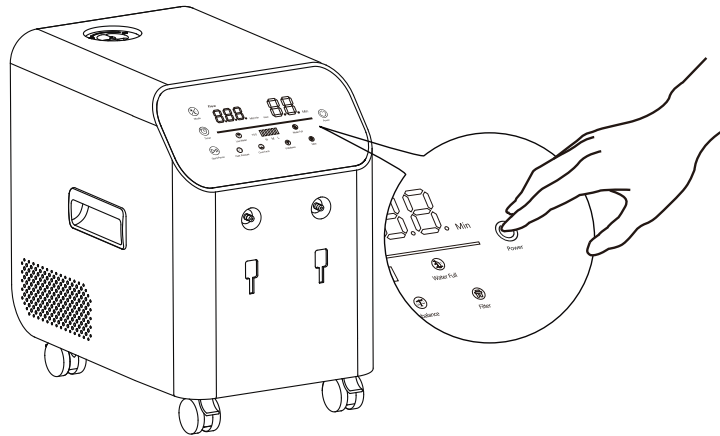

- ③ Press the “Timer” button to set working time: 30, 60, 90 minutes, 2, 3, 4 hours cycle setting, if continuous use for 4 hours, it is recommended to stop working for 1 hour before starting the machine.

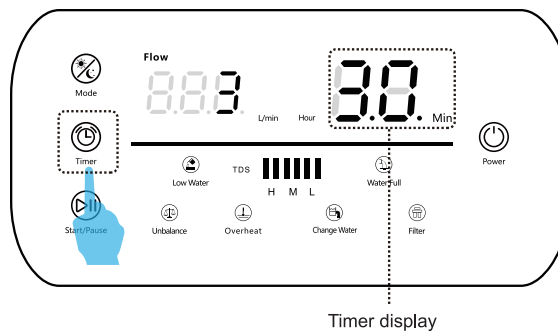

- ④ Press Start/Pause button to start the machine; Press the button again to Pause or Stop.

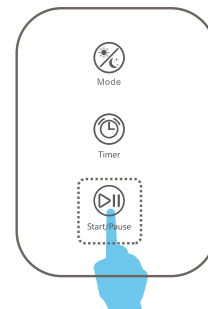

- ⑤ Press the day and night mode switch button, the display screen will dim for a few seconds, all display lights will turn off, and the remaining small dots will light up and flash, indicating that the instrument is working. This function is suitable for use when turning off the lights and sleeping at night.

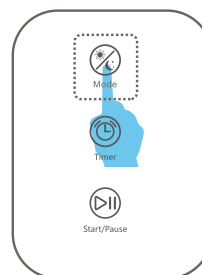

5.SMART SENSORS

① Low Water Indicator

Flashing “Low Water” icon indicates the water in the tank is less than “Min” water level. The machine will automatically stop working when water level is below the “Min” level and give a prompt Beep alarm. Add Distilled water to the “Max” water level line.

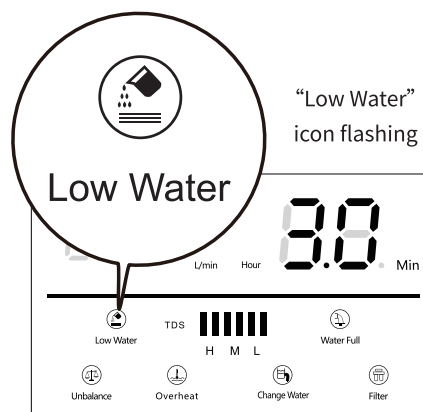

② Water Full

Flashing "Water Full" icon on the display indicates the water in the water tank is higher than the maximum water level and the blue water tank light will flash to prompt. It needs to drain some water and observe the water level on the back of the equipment. It is suitable to add 2L-2.6L of water at a time.

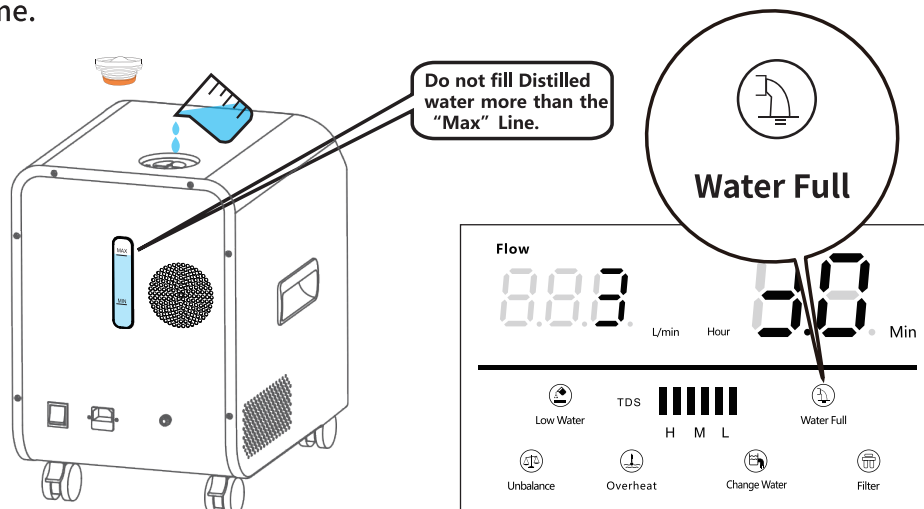

③ Unbalance Indicator

An “Unbalance” icon flashes when the machine is tilted or not on a flat surface, and a long Beep sound will alarm until the machine is laid flat.

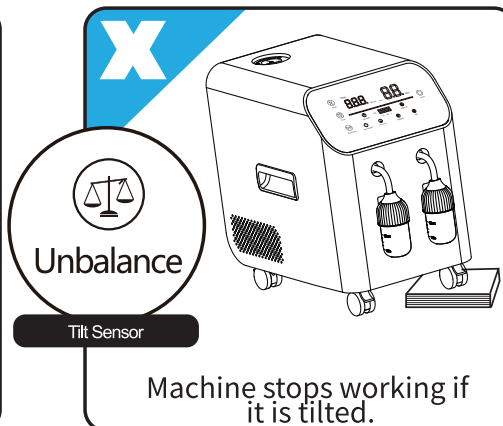
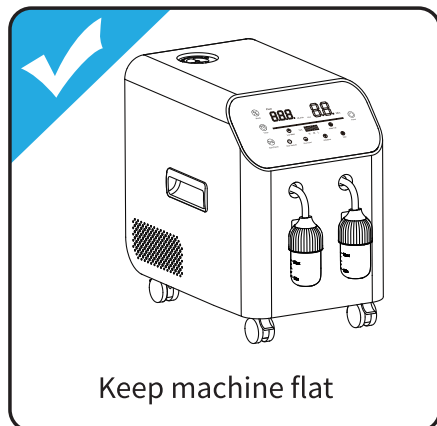

④ Over Heat Indicator

When the internal H2 production module is over heated, the machine stops working to protect the device, and the “OverHeat” icon flashes. Let the machine cool down, then re-start working. Observe if the H2 gas output in humidified bottle is normal. If it's abnormal, drain out all the water from the tank, and add new distilled water to speed up the cooling process, then re-start the machine.

“Over Heat”
icon

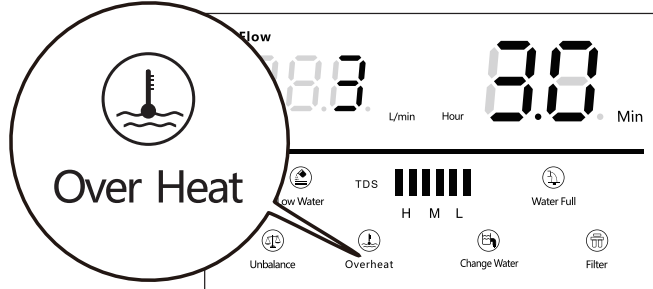

⑤ Change Water

When the machine works for half a month to a month, the Change Water icon will flash a prompt, please drain the water from the tank, go to Page 9 for how to drain water.

“Change Water”
icon

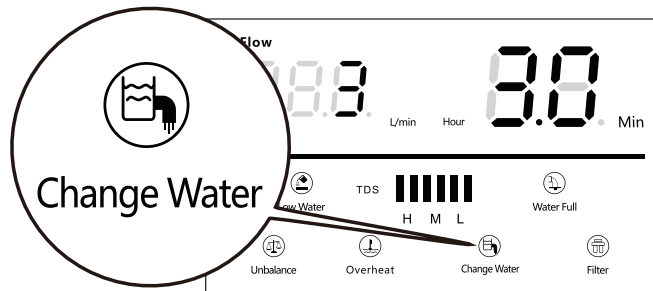

⑥ Water Quality Indicator (TDS)

TDS water quality sensor is built into the water tank to monitor water quality in real time. Water quality displays three grades: High (H), Medium (M), & Low (L). with corresponding colors in green, yellow and red. Flashing color icon indicates the current water quality level. Machine stops working when water quality is at Low (Red). Change to new Distilled water in the water tank, and re-start the machine when water quality returns to High (green). Make sure to change Resin Filter on a regular basis.

“TDS” icon

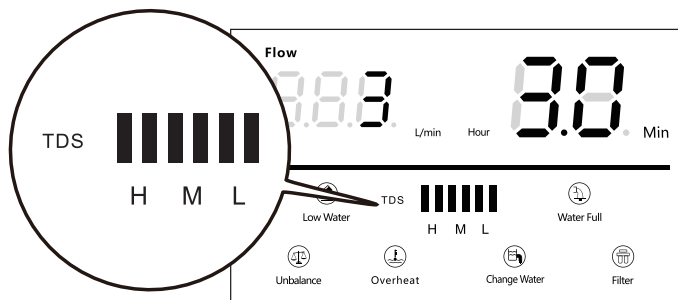

⑦ Resin Filter Replacement

The “Filter” icon flashes when the machine has been working for 6-12 months. Replace the Resin filter in the water tank by following the steps:

- ① Unscrew open the water tank cover (Fig.1).
- ② Take out the Resin filter by pulling it out (Fig. 2).
- ③ Replace to a new Resin filter (Fig. 3)
- ④ Insert the new Resin filter, and screw on the water tank cover tightly (Fig. 4)
- ⑤ **To Reset the Filter Indicator: Turn on the power, Press & Hold "Mode" button until it beeps twice.**

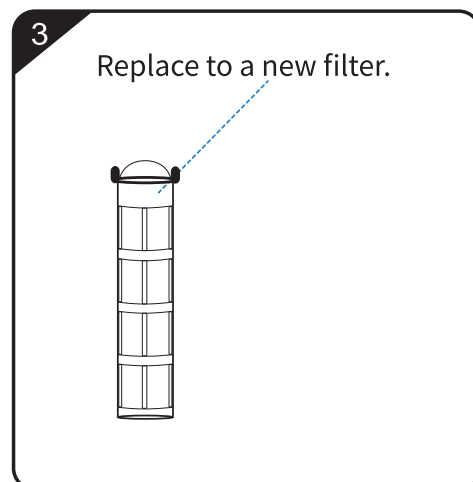
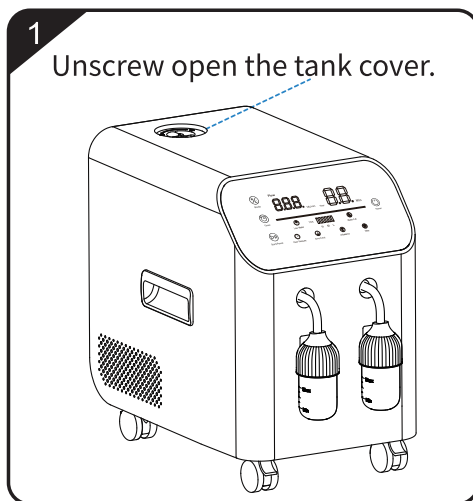

6.CHANGING WATER/DRAINING WATER

It is recommended to drain away water from the water tank & add to new Distilled water at least 2 times a month for the following situations:

- Long haul
- Over Heat
- Water is over max water level
- Adding improper water (Water Quality TDS is poor.)
- When machine is working, no gas is producing and display failure “Err” icon.

HOW TO DRAIN WATER

1. Unplug the power cord.

2. Prepare a bucket, connect the drain tube.(Right figure)

A. Unscrew the drain hole cap.

B. Pull out the silicone plug.

C. Connect the drain tube to drain hole.

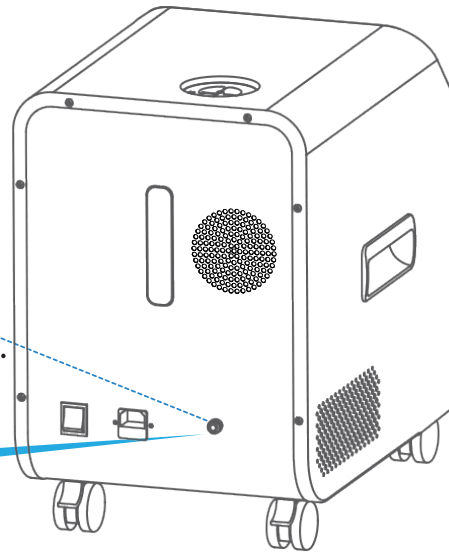

3. Unscrew open the top water tank cover, water will start draining out.Plug back in the silicone plug and screw on the drain hole cap.



(Tank cover)

Note: Keep the drain hose somewhere you can find it for future use.

7. CONNECTION SETUP FOR MULTIPLE USERS

Hydrogen /Oxygen flow output connections

CAUTION: DO NOT CONTACT WITH ANY FIRE & SPARKS

 Note: If mix hydrogen and oxygen in other ways, please purchase our company's special atomized hydrogen&oxygen humidification bottle.

For single use

Figure of flow output for

Single person Oxyhydrogen Inhalation at 3000 ml/min
(Hydrogen/Oxygen mixing)

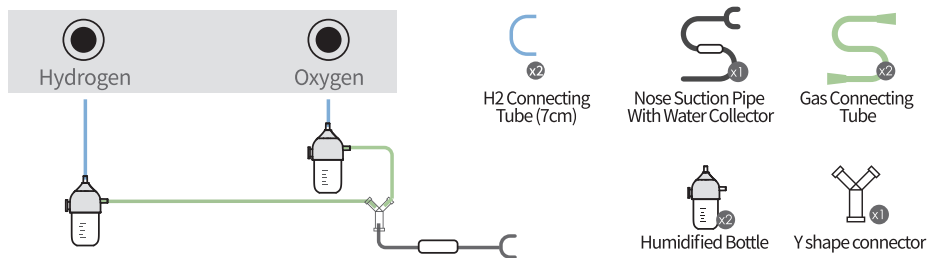

2 People Use

Figure of flow output for

(One person inhales Hydrogen outputs at 2000 ml/min,
another person inhales oxygen at 1000 ml/min.)

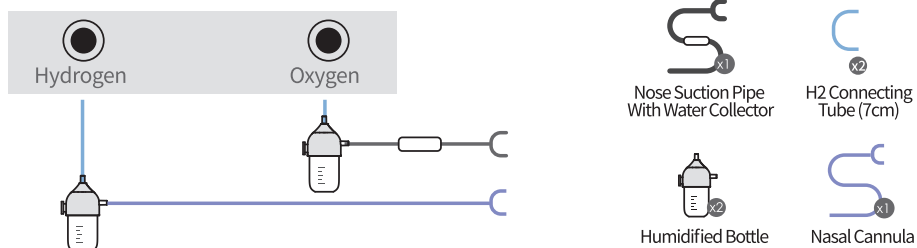

8.MAINTENANCE

Since the Hydrogen Inhaler uses distilled water, maintenance on the device is minimal under normal conditions & uses. But occasionally if you start to notice that your device is not producing H₂ normally or performing optimally, it may be due for service, cleaning or maintenance.

If you experiencing any of the following issues with the devices:

- Hydrogen Output is weaker.
- The device is not producing hydrogen water.
- There are no bubbles infused in the humidifier bottles.

9. FAQ

1	After finishing use, press power button to shutdown. After shutdown, the power wire cannot be removed immediately. The machine needs time to fully dissipate heat, please remove power wire until the fan stops completely. In case of sudden power failure during use due to force majeure factors, the power should be switched on again after an interval of 5 minutes.
2	It is normal to spray a small amount of water from O ₂ outlet when in use. When the water in humidified bottle reaches the Max line, open the bottle and remove to the middle line. Only no choking water, choking nose, please feel free to use.
3	When starting the machine, it is normal to spray a small amount of water from H ₂ & O ₂ outlets, because the water vapor accumulates in the pipeline after liquefaction. Please feel free to use.
4	When the machine is suspended, the cooling fan will accelerate the heat dissipation and automatically stop within 30 seconds, and the sound of the fan will be a little louder than when it is in use. This is a normal phenomenon. Please feel free to use.
5	The squeaking when in use is a normal phenomenon caused by water vapor separator drainage, please feel free to use.

10. WARNING & PRECAUTIONS

- Use ONLY Distilled Water (TDS=0) to this device. Using other water with poorer quality or with minerals may damage the machine.
- Turn off the Power Switch on the back of the machine to shut off the machine completely when not using the device, to prolong the life span of the machine.
- When using the H₂ inhaler for the first time, do not inhale for more than 30 mins per day. After your body is more accustomed to breathing in H₂ gas then gradually increase the total amount of time to more hours.
- It is recommended to replace the nasal cannula every 1~2 months depending on the frequency of usage. Each nasal cannula should be dedicated to one person for hygiene purposes.
- If the machine is not to be used for a long time, drain out most of the water and leave about 100-200 ml of distilled water in the machine to keep the electrode moisturized and to function properly when it's time to use it again.
- It is normal that a new machine have water inside. The water in the water tank is to protect and moisture the electrode in the machine. This water in the water tank is 100% clean pure distilled water.
- Do not block the Heat Cooling Vents when the machine is running. Make sure to operate the machine in a cool & ventilated environment.
- When the outdoor temperature is below 5°C , the machine must be placed at room temperature for 24 hours before use.
- Children or people who do have any experience should not operate the device without supervision or permission.
- If you are feeling any discomfort, stop using the device immediately and consult with your doctor.
- Do not disassemble, repair or modify the machine. Any tampering, modification, or improper use will void the warranty.